



CON-  
TEMPO-  
RARY

**INDICE - Contents**

3  
L'AZIENDA  
*Our Company*

4  
LA NOSTRA FILOSOFIA  
*Our philosophy*

4  
100% MADE IN ITALY  
*100% Made in Italy*

5  
L'ARTIGIANALITÀ  
*Craftsmanship*

5  
LA SOSTENIBILITÀ  
*Sustainability*



**L'AZIENDA**  
*our company*



Old Line è un'azienda che affonda le sue radici nella tradizione ebanistica veneta. Nata 40 anni fa da artigiani accomunati dall'amore per la lavorazione del legno, oggi è un'industria strutturata e punto di riferimento nel mondo della cucina tradizionale. Con alle spalle un importante bagaglio di esperienza nel settore, oggi la seconda generazione continua ad immettere sul mercato prodotti dal design classico, contestualizzati in una modernità compositiva per l'arredo di spazi esclusivi. L'utilizzo di materiali pregiati, la cura dei dettagli e di soluzioni tecniche innovative, sono la chiave per la realizzazione di cucine accoglienti, ospitali, funzionali e di raffinata eleganza.

*Old Line's roots are deeply embedded in the cabinet-making tradition of the Veneto region in Italy. Established 40 years ago by artisans who shared a love for timber, ours is now a well-organised company that others in the world of traditional kitchens look up to. Thanks to a heritage of great experience in the sector, the second generation at the helm of the company is still making classic furniture for the market, now contextualised in modern layouts to furnish exclusive spaces. Prized materials, care to detail and innovative technical solutions are the keys to building inviting, cosy, functional and exquisitely elegant kitchens.*

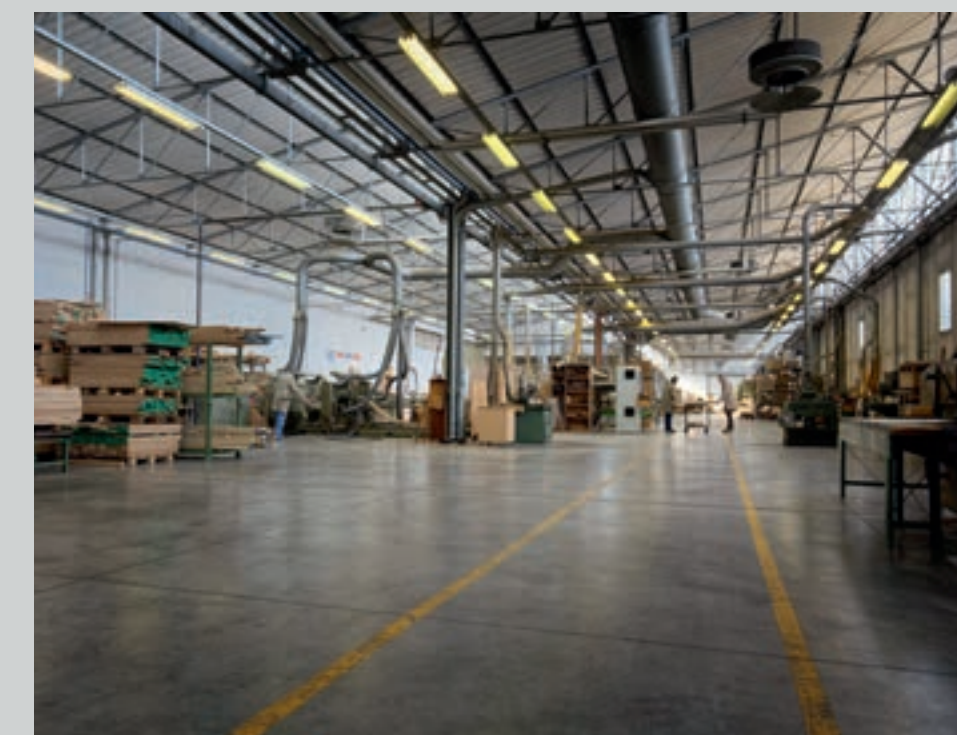



## LA NOSTRA FILOSOFIA *our philosophy*

Recupero e valorizzazione della tradizione.

Questi sono i cardini attorno ai quali ruota la nostra filosofia aziendale. Old Line, infatti, proprio perché nata come piccola realtà artigianale, non ha mai scordato le proprie origini. A quest'ultima continua infatti ad attingere, in un continuo processo innovativo dove la tradizione si sposa con le più moderne tecniche produttive.

Attraverso la valorizzazione del know-how tramandato di padre in figlio, l'azienda è oggi espressione di un'imprenditorialità sostenuta da una genuina passione per il legno e per il design.

*To bring back and enhance tradition.*

*This is the cornerstone of our company philosophy.*

*In fact, since we started as a small, woodworking business, we have never forgotten our origins and we keep drawing from them, in an ongoing process of innovation in which tradition is paired with the most modern production technologies. By making the most of the know-how handed down from father to son, today our company's business skills are backed up by an authentic passion for wood and design.*



## 100% MADE IN ITALY *100% made in italy*

Per Old Line il Made in Italy è un'imprescindibile caratteristica dei propri prodotti. Ogni componente viene infatti lavorato all'interno dell'azienda, dal più semplice al più complesso.

Solo così è possibile garantire l'intera filiera produttiva, con un costante e capillare controllo della qualità dei materiali e delle finiture, per ottenere mobili di eccellenza caratterizzati da un inconfondibile stile italiano.

*The furniture produced by us at Old Line is entirely Made in Italy: an intrinsic and indispensable feature of all our products. Each part, no matter how simple or complex, is made on our premises. We know no other way to guarantee the entire production chain, by means of thorough, ongoing quality controls carried out on materials and finishes to obtain top-quality furniture marked by the unmistakable Italian style.*

## L'ARTIGIANALITÀ *craftsmanship*

Artigianalità, ovvero saper costruire con amore, come un tempo. Per Old Line questo aspetto fa parte del dna aziendale perché le nostre origini sono proprio quelle di artigiani del legno.

Scegliamo con cura i materiali, selezionandoli e testandoli, consapevoli che la bontà della materia prima è fondamentale per l'ottenimento di prodotti di alta qualità. Nelle lavorazioni impieghiamo tutta la nostra competenza, curando ogni dettaglio, forti di una consolidata esperienza ebanistica.

*Craftsmanship means knowing how to make things with love and care, just like they used to be in the past. Since we started out as cabinet makers, this is still an intrinsic part of our makeup. We choose our materials carefully, selecting them and testing them, well aware that excellent raw materials are essential to make a top-quality product. We invest all our skills in crafting our furniture, taking care of every detail, backed up by our sound experience as cabinet makers.*



## LA SOSTENIBILITÀ *sustainability*

La salvaguardia dell'ambiente è da sempre un aspetto basilare per Old Line.

I nostri processi produttivi vengono continuamente ottimizzati, controllati ed aggiornati.

L'utilizzo di energia elettrica autoprodotta copre fino al 50% del fabbisogno energetico, prezioso contributo ad un processo virtuoso di effettiva eco-sostenibilità.

*For us at Old Line, environmental awareness is essential. Our production processes are continuously optimised, checked and updated. Up to 50% of our electricity requirements are self-produced: an important contribution to a virtuous process of authentic eco-sustainability.*

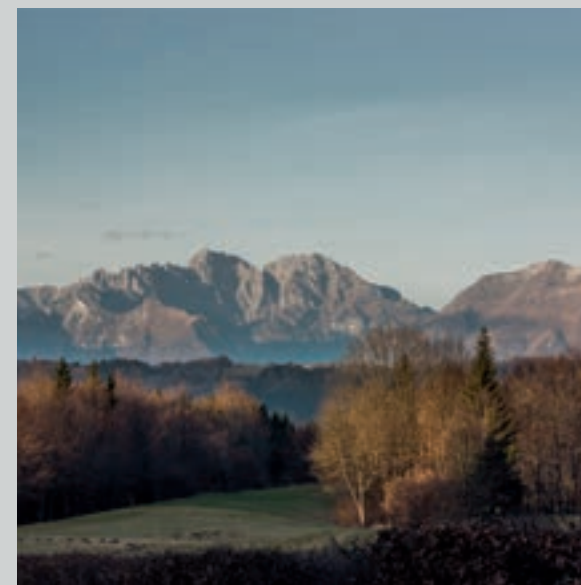



LE PROPOSTE - *the proposal*

8  
COMPOSIZIONE 1  
*Arrangement 1*

28  
COMPOSIZIONE 2  
*Arrangement 2*

44  
COMPOSIZIONE 3  
*Arrangement 3*

58  
COMPOSIZIONE 4  
*Arrangement 4*

74  
COMPOSIZIONE 5  
*Arrangement 5*



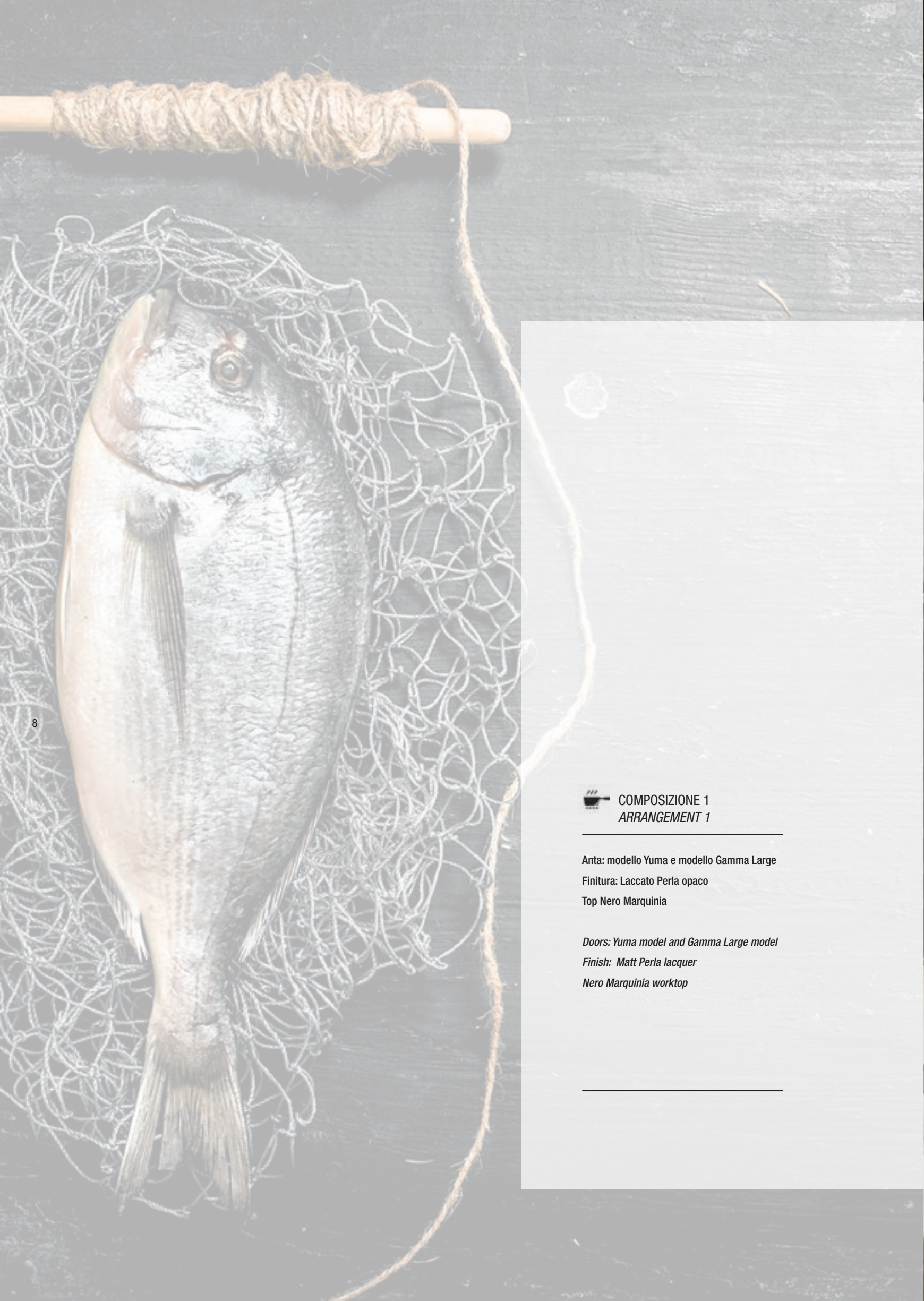

8



**COMPOSIZIONE 1  
ARRANGEMENT 1**

Anta: modello Yuma e modello Gamma Large  
Finitura: Laccato Perla opaco  
Top Nero Marquinia

Doors: Yuma model and Gamma Large model  
Finish: Matt Perla lacquer  
Nero Marquinia worktop



9







Frontali modello Gamma Large, in finitura  
laccato Perla opaco.

Matt Perla lacquered Gamma Large fronts.











Vetrine telaio alluminio finitura grafite, con vetro fumè, retroilluminazione a led lateralmente. Ripiani interni con telaio alluminio finitura grafite e vetro trasparente.

Glazed doors with Grafite finish aluminium frames, smoked glass and led side lighting. The transparent glass interior shelves have Grafite finish aluminium frames.













MODELLO GAMMA  
*Gamma model*

Trama Large  
*Trama Large*



Trama Small  
*Trama Small*

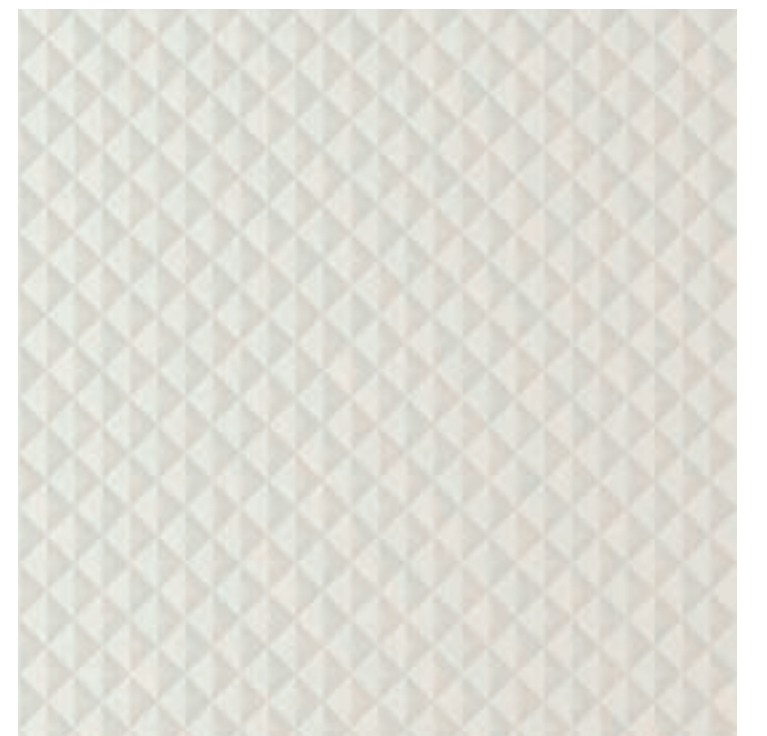







**SCHEDA TECNICA**  
**COMPOSIZIONE 1**  
*Technical information for*  
**Arrangement 1**

ANTA  
Door



YUMA

ANTA  
Door



GAMMA LARGE

**FINITURE UTILIZZATE**  
*Finishes used*

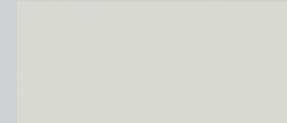

Laccato Perla Opaco  
*Matt Perla lacquer*



Top Nero Marquinia  
*Nero Marquinia worktop*

**VISTA IN PIANTA**  
*Plan*

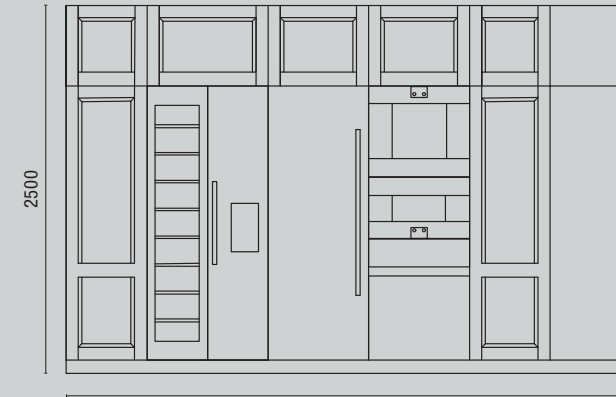
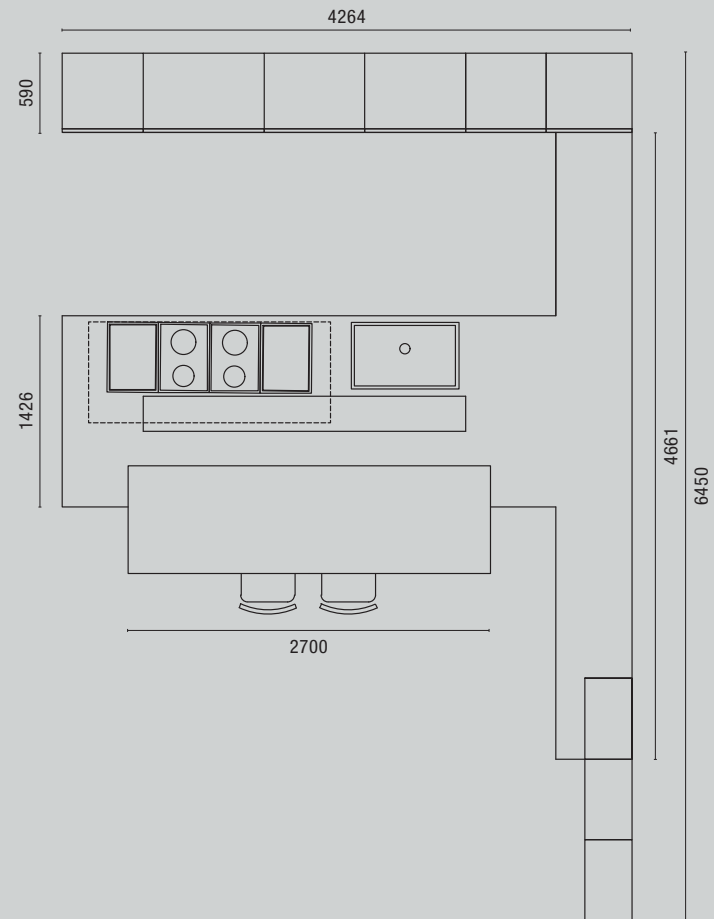

PROSPETTO A-A  
*Front view A-A*

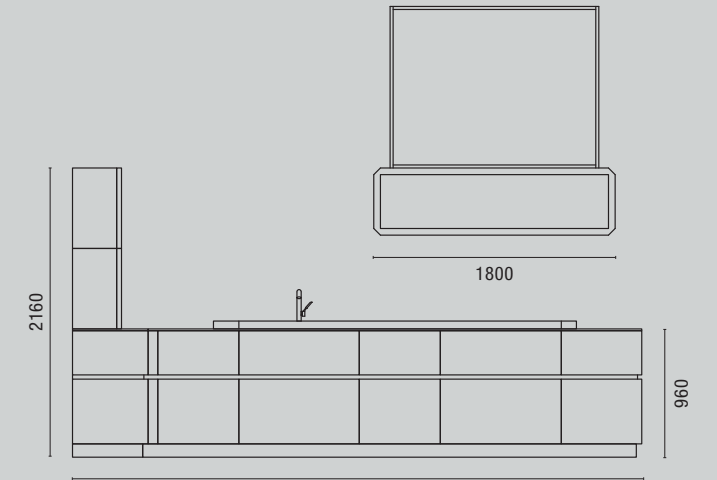

PROSPETTO B-B  
*Front view B-B*

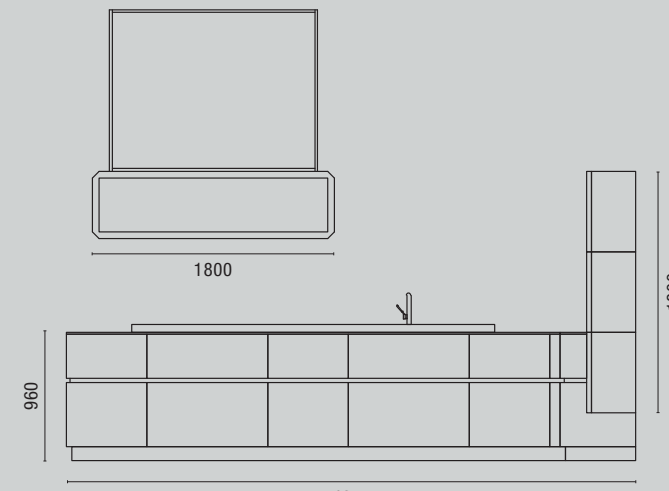

PROSPETTO C-C  
*Front view C-C*

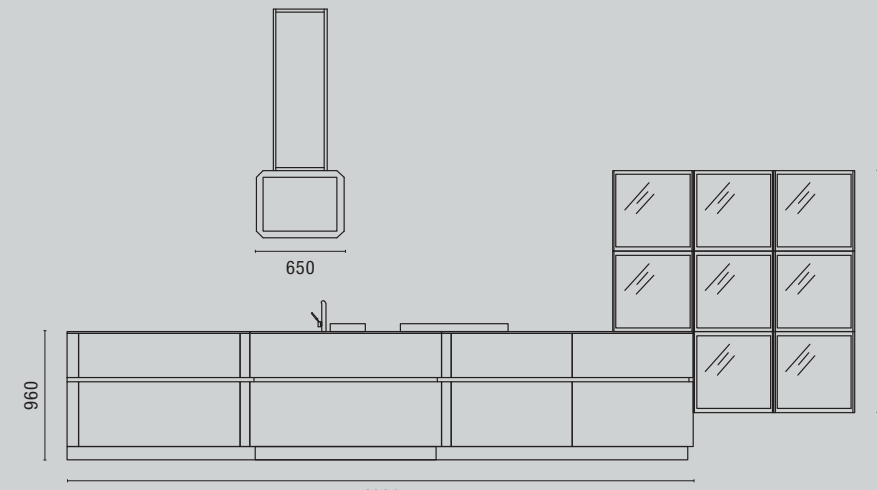

PROSPETTO D-D  
*Front view D-D*



 **COMPOSIZIONE 2**  
**ARRANGEMENT 2**

Anta: modello Yuma  
Finitura: Laccato Bianco opaco  
Rovere Naturale  
Top Grigio Imperiale

*Doors: Yuma model*  
*Finish: Matt Bianco lacquer*  
*Natural Oak*  
*Grigio Imperiale worktop*











Tavolo modello Paestum in Rovere Naturale in abbinamento a sedute Ares con rivestimento ecopelle.

Paestum table in Natural Oak paired with Ares chairs covered with eco-leather.









Elemento isola con blocco centrale in Rovere Naturale massello e due cestoni sotto lavello da 120 cm. Lavello e vasche contenitive in finitura Grigio Imperiale come il piano di lavoro.

Island with solid Natural Oak central unit and two, 120-cm wide deep drawers below the sink. Grigio Imperiale sink and basins matching the worktop.















**SCHEMA TECNICA**  
**COMPOSIZIONE 2**  
*Technical information for*  
**Arrangement 2**

ANTA  
 Door



YUMA

VISTA IN PIANTA  
 Plan

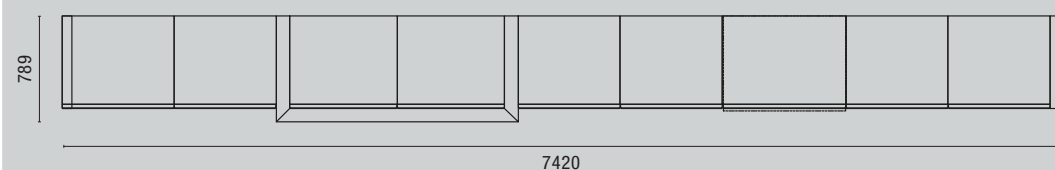

7420

789

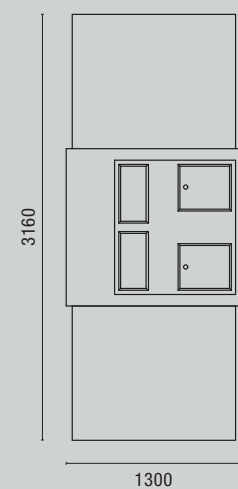

1300

3160

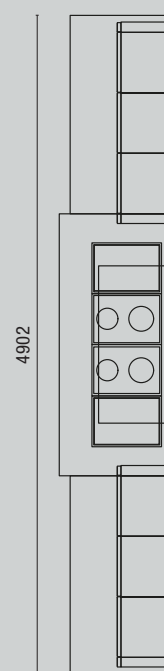

790

4902

FINITURE UTILIZZATE  
 Finishes used



Rovere Naturale  
 Natural Oak

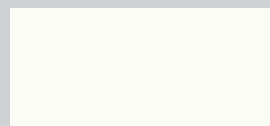

Laccato Bianco Opaco  
 Matt Bianco lacquer

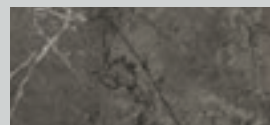

Top Grigio Imperiale  
 Grigio Imperiale worktop



PROSPETTO A-A  
 Front view A-A

7420

2840

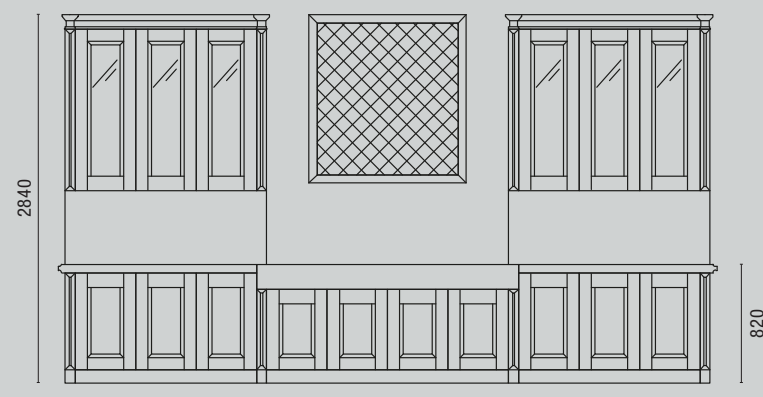

PROSPETTO B-B  
 Front view B-B

4902

2840

820

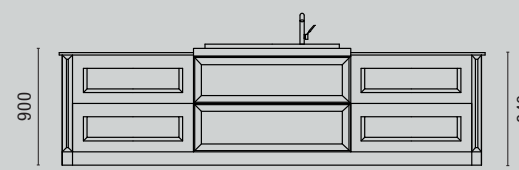

PROSPETTO C-C  
 Front view C-C

3160

900

840

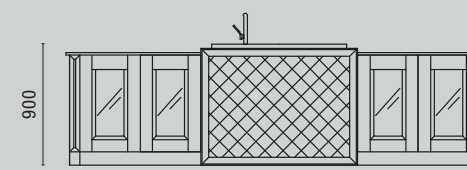

PROSPETTO D-D  
 Front view D-D

3160

900

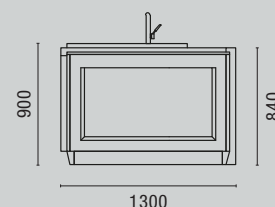

PROSPETTO E-E  
 Front view E-E

1300

900

840

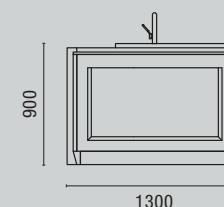

PROSPETTO F-F  
 Front view F-F

1300

900





**COMPOSIZIONE 3  
ARRANGEMENT 3**

**Anta:** modello Yuma  
**Finitura:** Resina Kerakoll WR08,  
 Rovere Naturale  
**Top:** Pietra Piasentina

**Doors:** Yuma model  
**Finish:** Resina Kerakoll WR08,  
 Natural Oak  
**Pietra Piasentina worktop**









Una cucina altamente performante mette noi al centro del progetto ed è ciò che accade in questa proposta, dove la disposizione di piano cottura, lavello e mensola snack, ruota intorno allo chef.

A kitchen featuring superior performances focuses on the user: in this arrangement the position of the hob, sink and snack bar revolve around the chef.













Madia finitura Rovere Naturale e resina Kerakoll WR08, con boiserie in Pietra Piasentina, mensole in plexiglass impiallacciato rovere retroilluminate.

Natural Oak finish and Resina Kerakoll WR08 sideboard with Pietra Piasentina wall panels and rear-lit, oak veneered, Plexiglas floating shelves.







**SCHEDA TECNICA**  
**COMPOSIZIONE 3**  
*Technical information for*  
**Arrangement 3**

ANTA  
Door



YUMA

ANTA  
Door



ALPHA

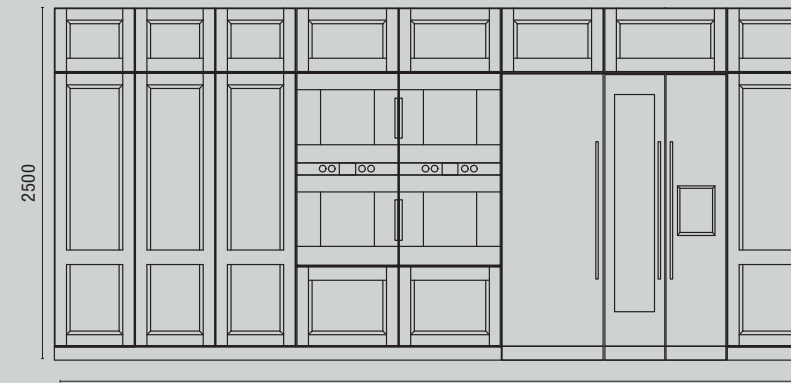

PROSPETTO A-A  
Front view A-A

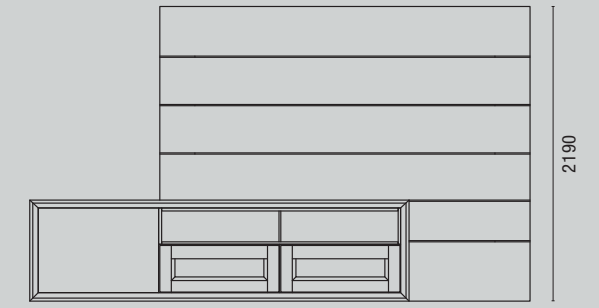

PROSPETTO B-B  
Front view B-B

**FINITURE UTILIZZATE**  
*Finishes used*

56



Rovere Naturale  
Natural Oak

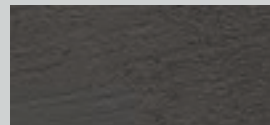

Resina Kerakoll WR08  
Resina Kerakoll WR08

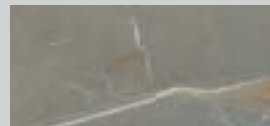

Top Pietra Piasentina  
Pietra Piasentina worktop

**VISTA IN PIANTA**  
*Plan*

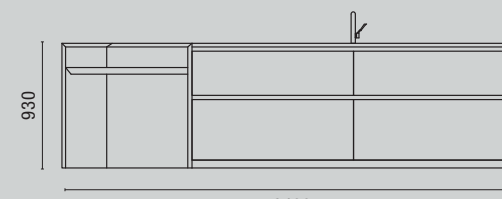
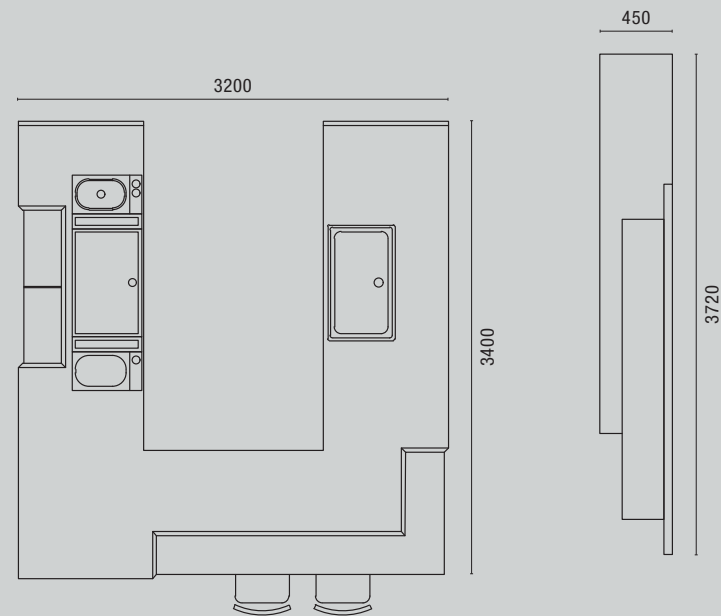
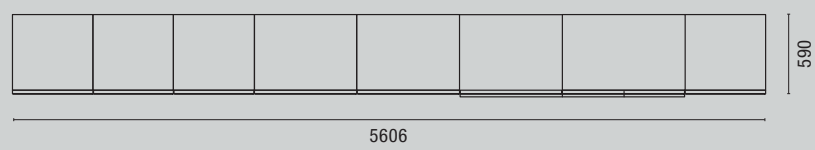

PROSPETTO C-C  
Front view C-C

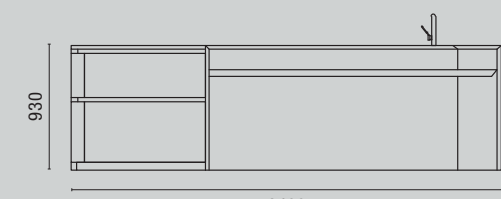

PROSPETTO D-D  
Front view D-D

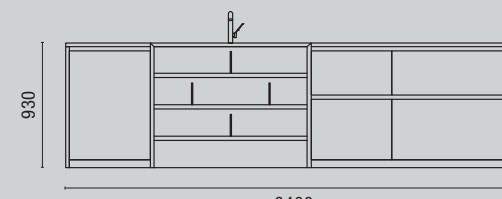

PROSPETTO E-E  
Front view E-E

57



 **COMPOSIZIONE 4**  
**ARRANGEMENT 4**

---

**Anta:** modello Yuma  
**Finitura:** Laccato Bianco opaco,  
Noce Canaletto  
**Top** Fior di Bosco

**Doors:** Yuma model  
**Finish:** Matt Bianco lacquer,  
Black walnut  
**Fior di Bosco worktop**

---









Nella sua semplicità di forma, questo tavolo mette in risalto la bellezza del legno massiccio naturale e l'assoluta raffinatezza dei delicati raccordi in legno inseriti a contrasto lungo le spaccature.

The simple shape of this table sets off the beauty of natural, solid wood and the pure refinement of the discreet wooden straps fitted across – and contrasting with – the cracks.









Il tavolo come prolungamento dell'isola con piano cottura e lavello, oltre che a rappresentare un'elegante soluzione estetica, rappresenta inoltre un elemento funzionale alla convivialità della famiglia e degli ospiti.

The table extending the surface of the island – fitted with a hob and sink – is a very elegant, beautiful and practical way of sitting your family and guests down to enjoy a good meal together.

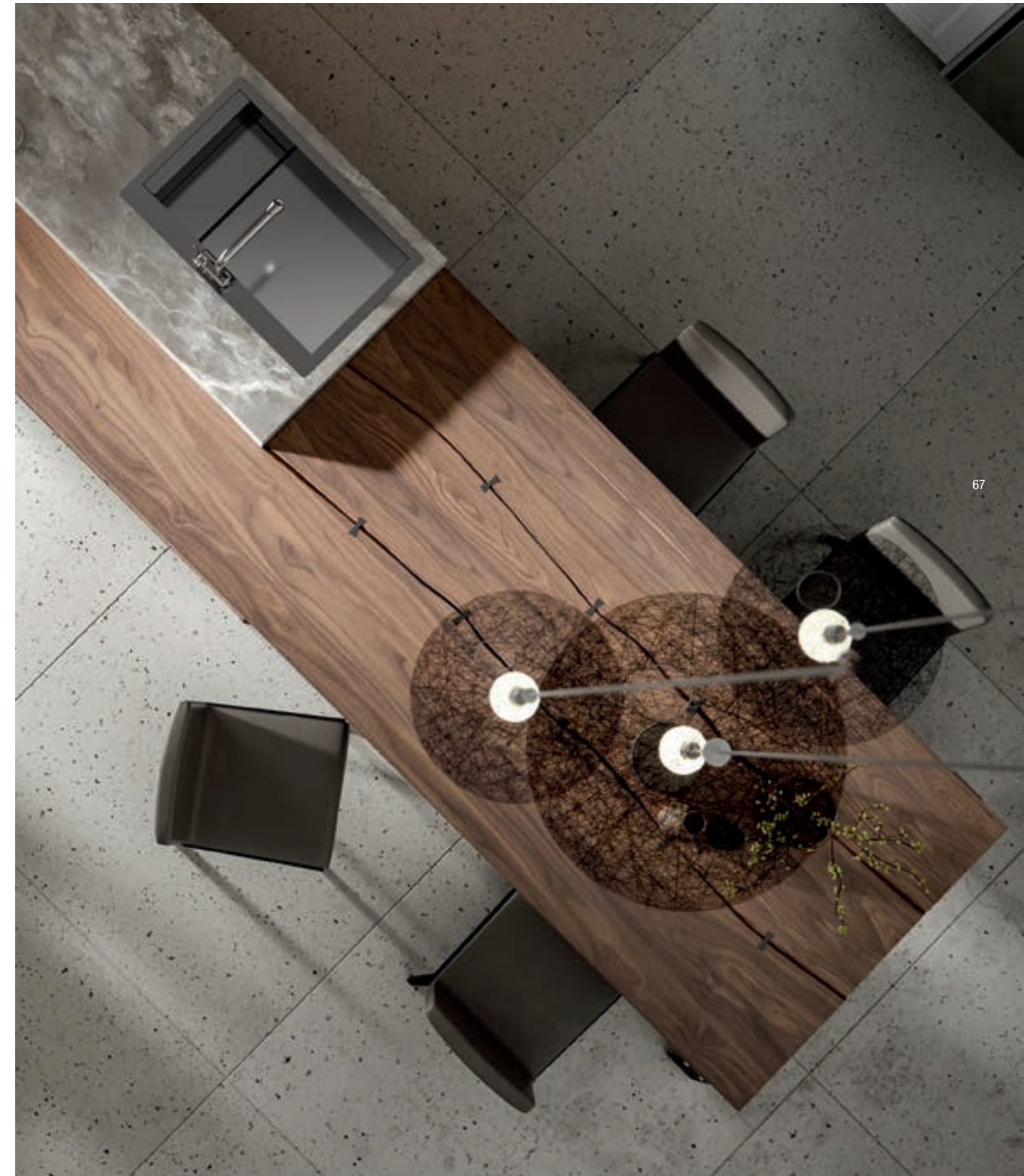





Le colonne di contenimento con ante apribili a 180°, possono essere al loro interno composte e modificate a piacere, per una cucina totalmente a vista, dinamica e aperta, dove riporre stoviglie, utensili, spezie e alimenti.

The inside of tall units - with 180° opening doors - can be accessorised at will. They can be fitted with glass doors for a fully transparent, dynamic and open kitchen offering plenty of storage space for tableware, utensils, herbs and spices as well as groceries.











**SCHEDA TECNICA**  
**COMPOSIZIONE 4**  
*Technical information for*  
**Arrangement 4**

ANTA  
Door



YUMA

ANTA  
Door



ALPHA



PROSPETTO A-A  
Front view A-A

VISTA IN PIANTA  
Plan

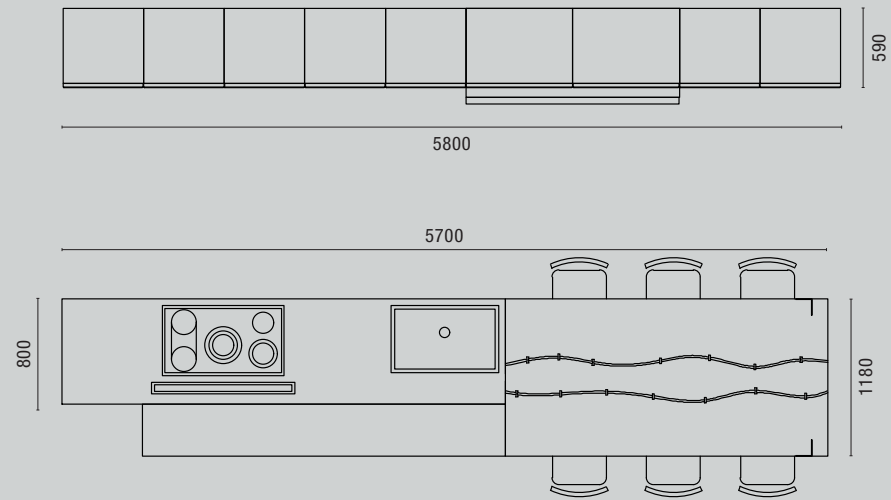

FINITURE UTILIZZATE  
Finishes used



Noce Canaletto  
Black walnut

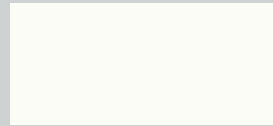

Laccato Bianco Opaco  
Matt Bianco lacquer

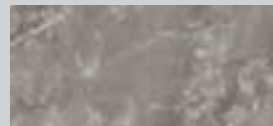

Top Fior di Bosco  
Fior di Bosco worktop

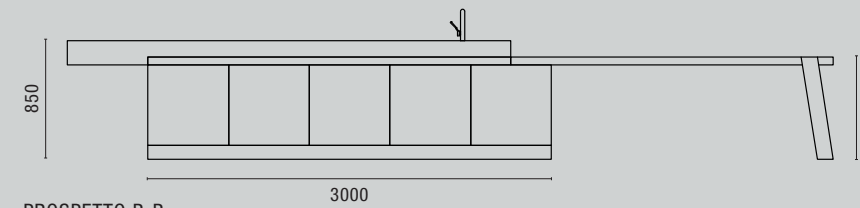

PROSPETTO B-B  
Front view B-B

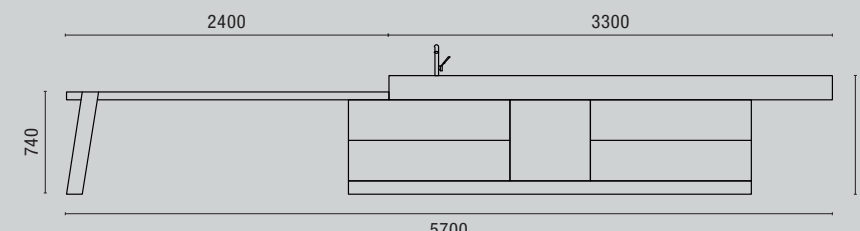

PROSPETTO C-C  
Front view C-C



 **COMPOSIZIONE 5**  
**ARRANGEMENT 5**

**Anta:** modello Yuma  
**Finitura:** Acciaio, Noce Canaletto  
**Top:** Pietra Piasentina

**Doors:** Yuma model  
**Finish:** Steel, Black walnut  
**Pietra Piasentina worktop**







Anta in acciaio inox pressofuso, un materiale eterno, affascinante e funzionale, ideale per l'igiene in cucina, facilmente lavabile e biologicamente neutro, oltre ad essere un prodotto eco-friendly e riciclabile al 100%.

The doors are in die cast stainless steel, an ageless, fascinating and functional material which is perfectly hygienic, easy to clean and biologically neutral as well as being eco-friendly and 100% recyclable.







La capacità contenitiva di basi e pensili, si amplia grazie ai vani a giorno con struttura metallica tinta grafite che ben si sposano con il legno e l'acciaio di struttura e frontali.

The open shelves with their Grafite finish aluminium structures add to the storage capacities of base and wall units while going wonderfully with the wood and steel of the cabinet carcasses and fronts.















**SCHEMA TECNICA**  
**COMPOSIZIONE 5**  
*Technical information for*  
**Arrangement 5**

ANTA  
Door



YUMA

ANTA  
Door



ACCIAIO

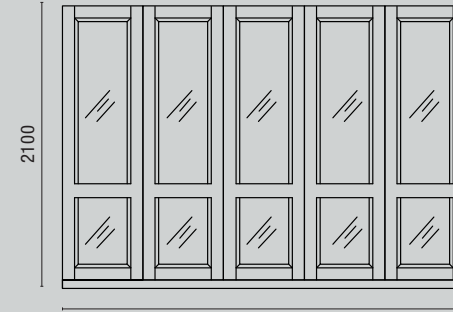

PROSPETTO A-A  
Front view A-A

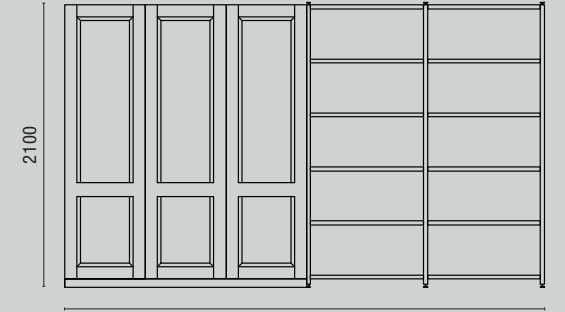

PROSPETTO B-B  
Front view B-B

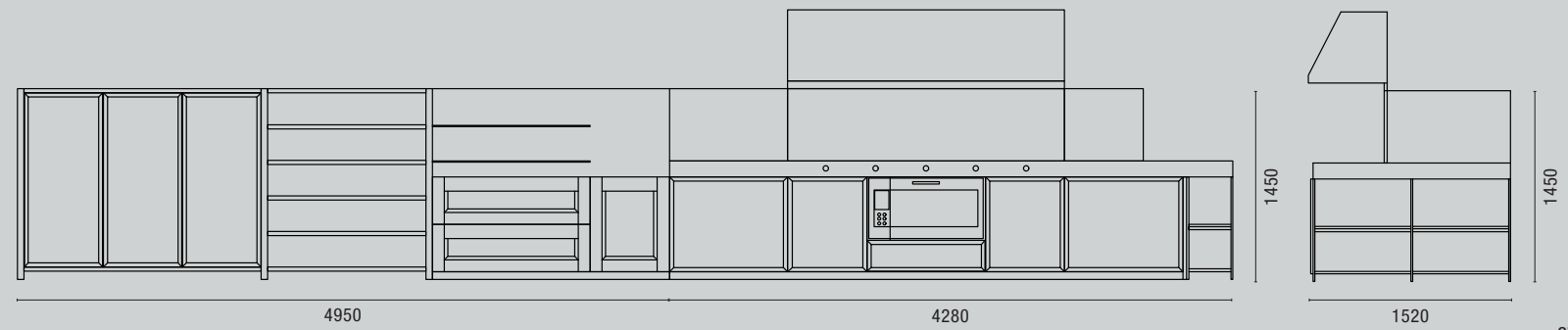

PROSPETTO C-C  
Front view C-C

PROSPETTO D-D  
Front view D-D

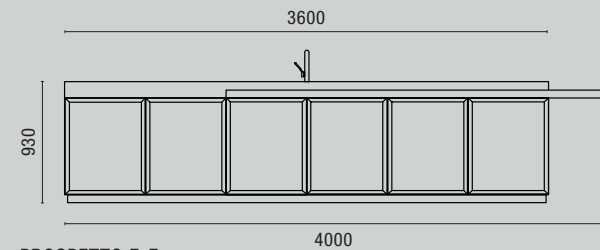

PROSPETTO E-E  
Front view E-E

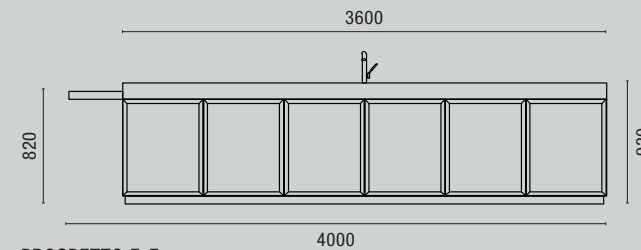

PROSPETTO F-F  
Front view F-F

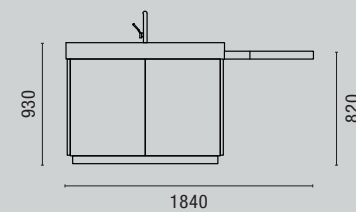

PROSPETTO G-G  
Front view G-G

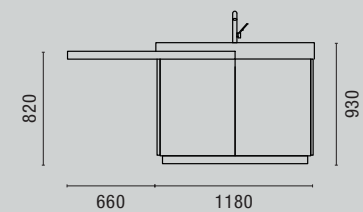

PROSPETTO H-H  
Front view H-H

VISTA IN PIANTA  
Plan

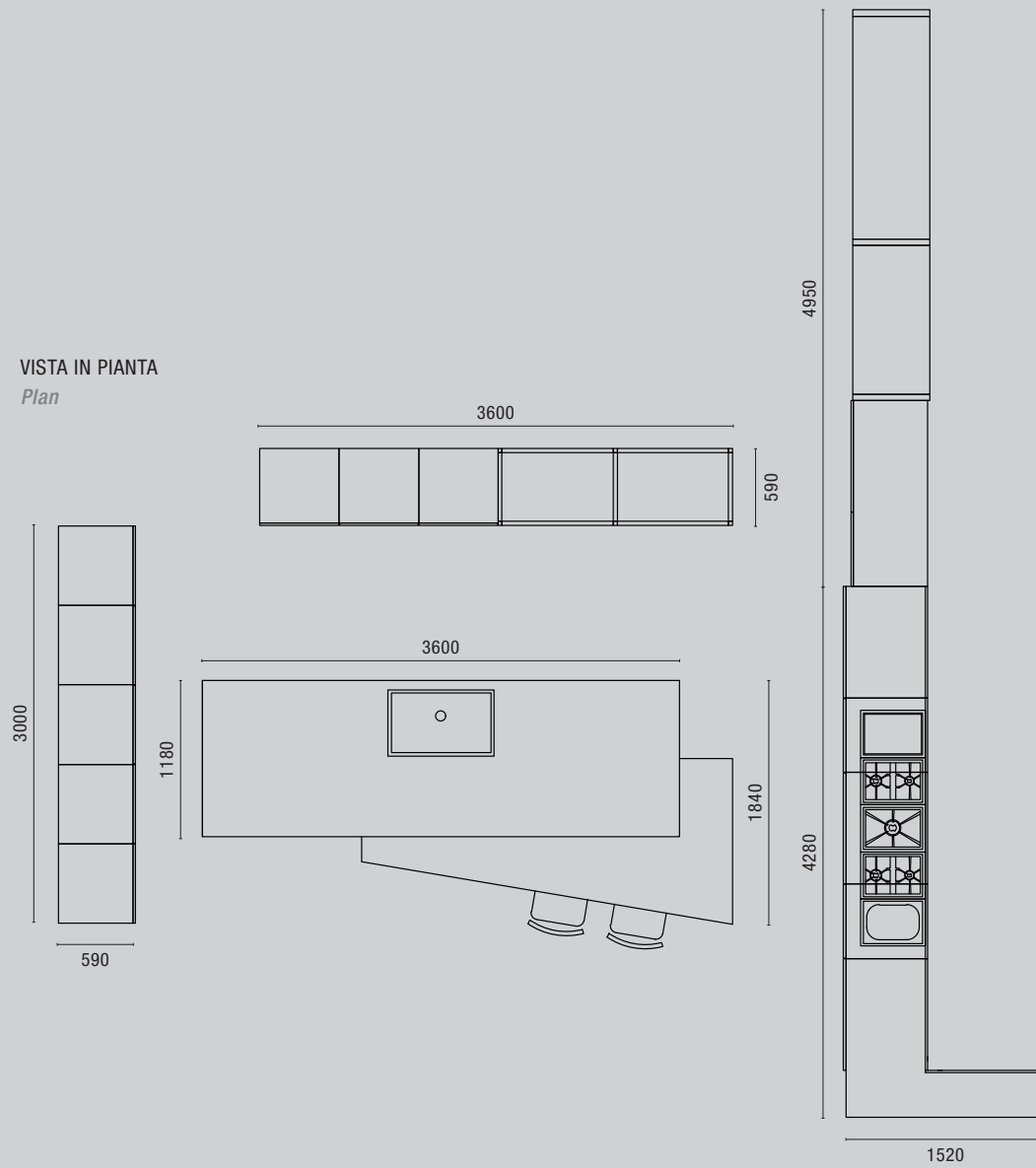

FINITURE UTILIZZATE  
Finishes used



Noce Canaletto  
Black walnut

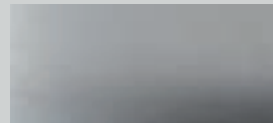

Acciaio  
Steel

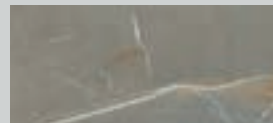

Top Pietra Piasentina  
Pietra Piasentina worktop



# TAVOLI

TABLES

SOUNION

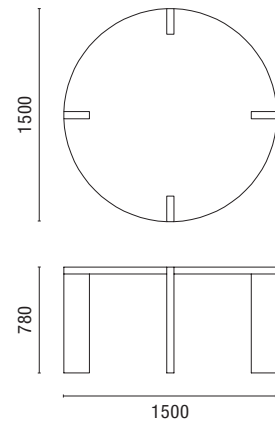

EPICURO

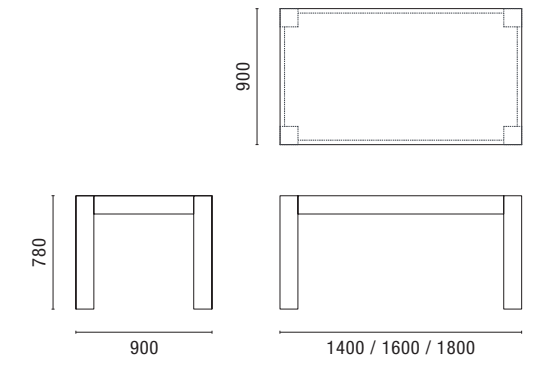

OLYMPIA

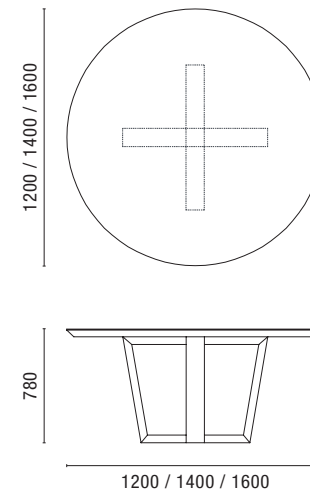

SEGESTA

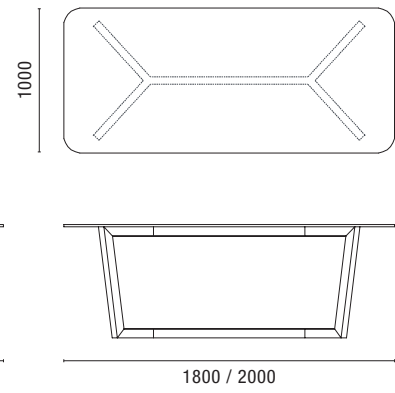

CIRENE

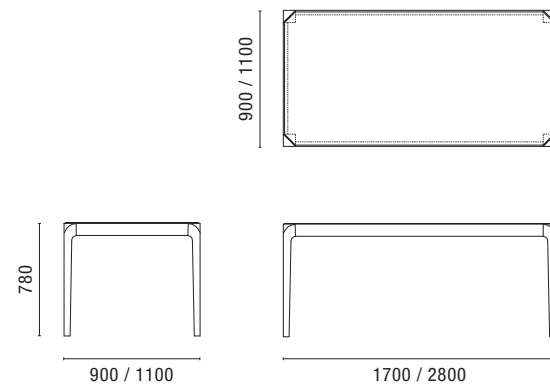

PAESTUM

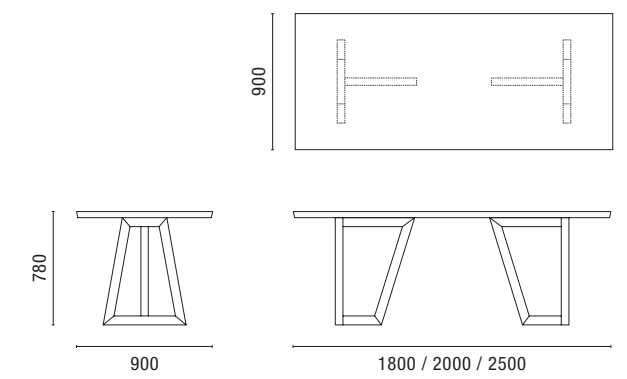



# SEDIE CHAIRS

## RIVESTIMENTI COVERINGS



2B9 ecopelle / eco-leather



4G9 ecopelle / eco-leather



3020-102 tessuto / fabric

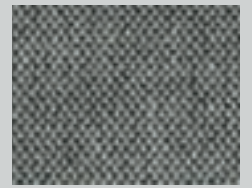

3020-119 tessuto / fabric

### ADE

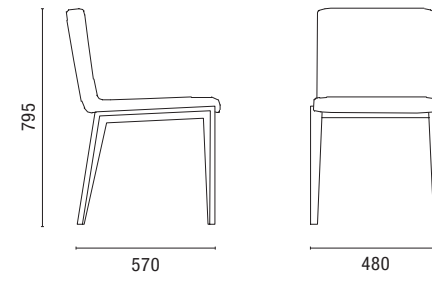

### GEA

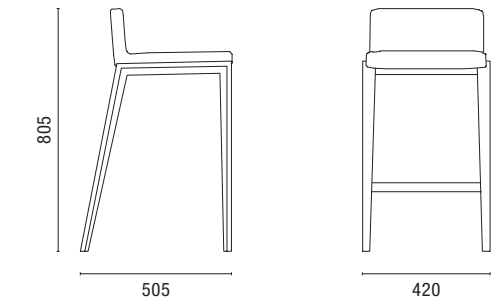

### ARES

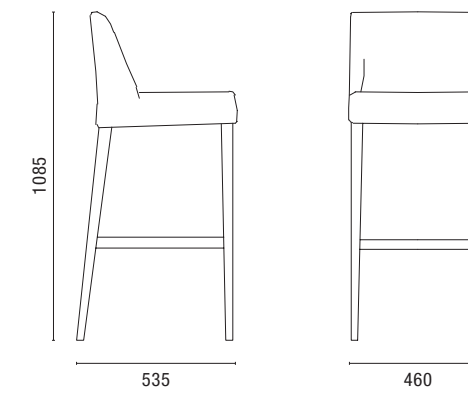
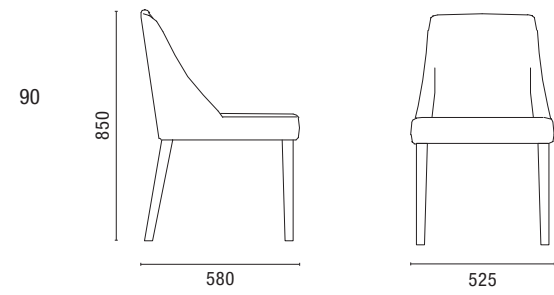

### TETI



91

### EKO

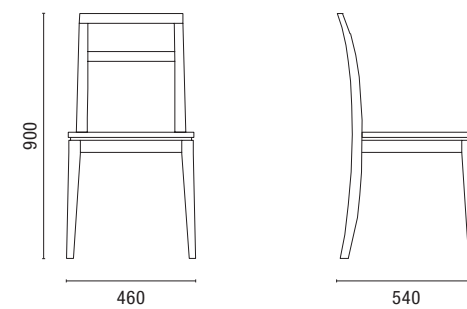

### ARIA

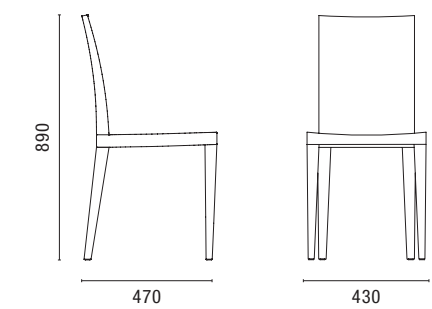



# ANTA YUMA

YUMA DOOR

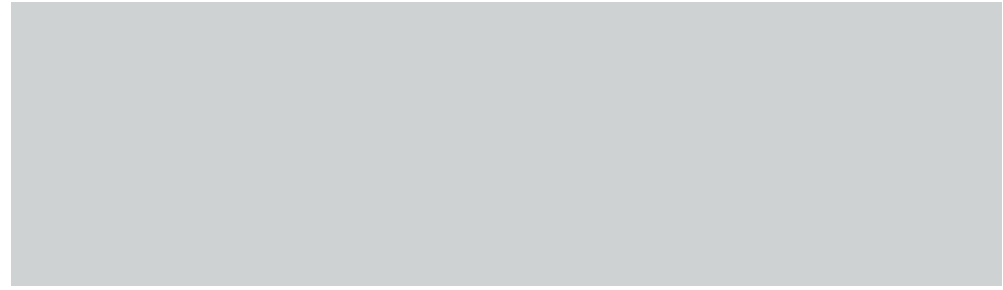

# FINITURE

FINISHES

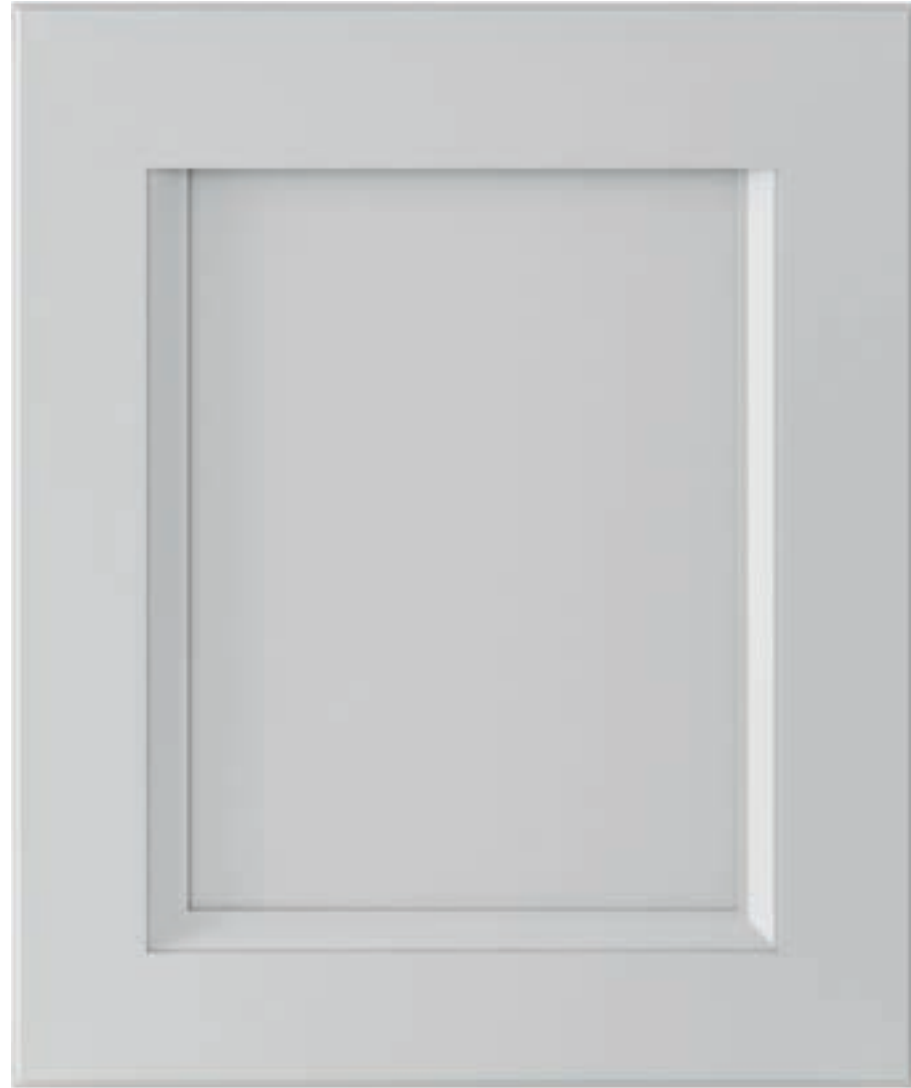
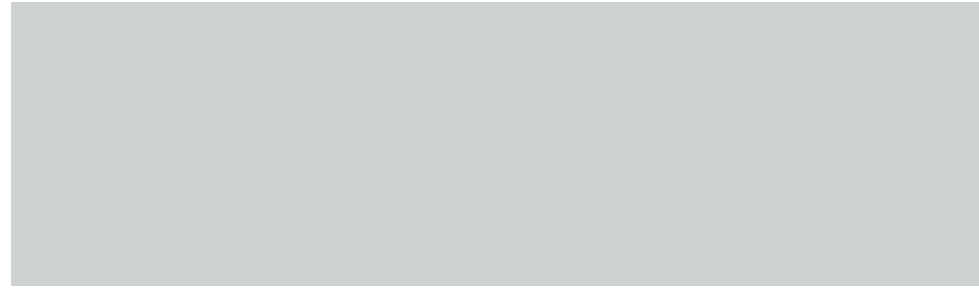

ANTA SPESSORE 30 mm  
30 mm thick door

30 mm



NOCE CANALETTO / BLACK WALNUT



ROVERE NATURALE / NATURAL OAK

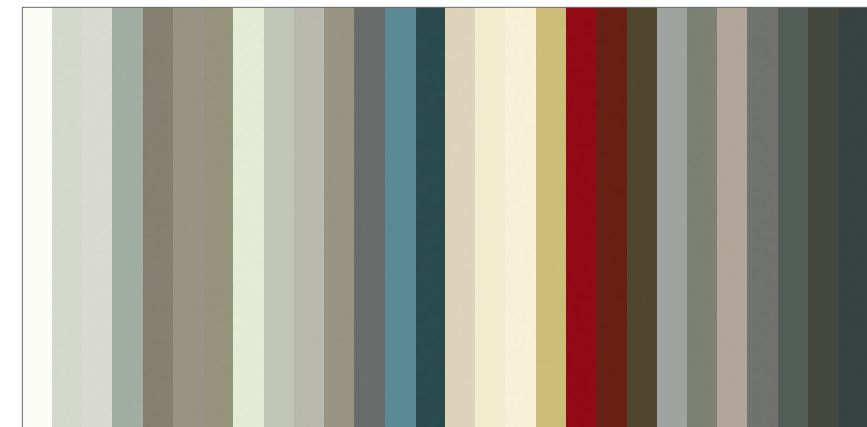

LACCATO PORO APERTO - LACCATO PORO CHIUSO / OPEN-PORE LACQUER - CLOSED-PORE LACQUER



# LACCATI NCS

LACQUERED NCS

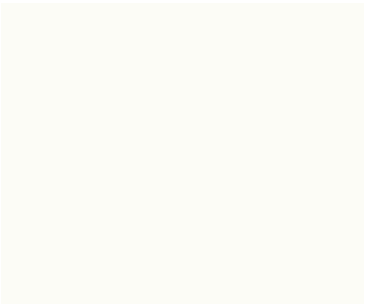
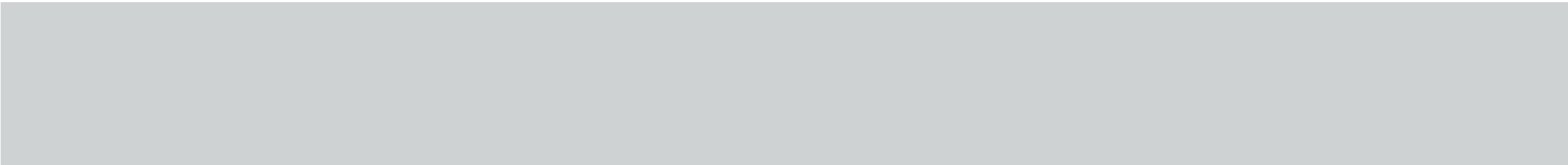

BIANCO • 0300-N



SETA • 1502-G50Y

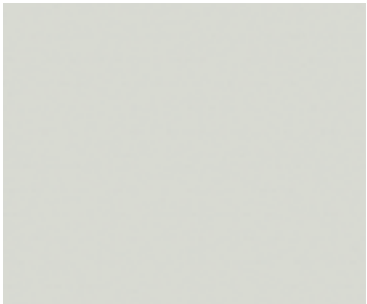

PERLA • 1500-N



POLVERE • 3005-G20Y



CASTORO • 5005-Y20R



CENERE • 5005-Y50R



CAPPUCCINO • 4010-G90Y



BOSCO • 7010-B30G

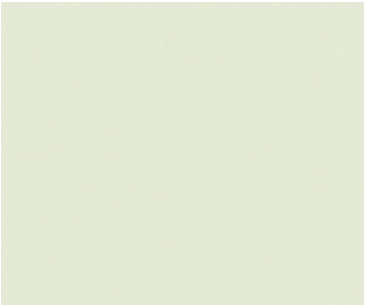

NEBBIA • 1005-G70Y



FUMO • 2005-G60Y



RUGIADA • 2502-Y



TORTORA • 4005-Y20R



PIOGGIA • 6000-N



NUVOLA • 4020-B10G



PETROLIO • 7010-B10G



PIETRA • 4005-B20G

94



AVORIO • 1505-Y30R

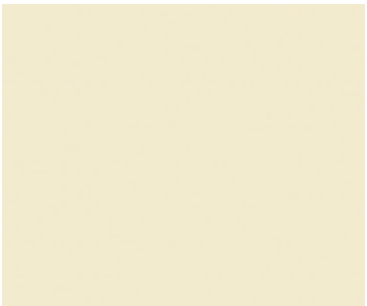

CANAPA • 0907-Y10R

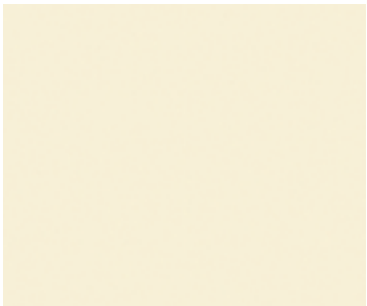

CORDA • 0804-Y30R



SABBIA • 2030-G90Y



RUBINO • 2570-R



TERRA • 6030-Y90R



CAFFÈ • 7010-Y70R



CORTECCIA • 8000-N

95



COLOMBA • 3500-N



OMBRA • 5005-G80Y



SENAPE • 3005-Y50R



DAINO • 5502-Y



PIOMBO • 6502-G



CARBONE • 7502-Y



GRAFITE • 7502-B



NERO • 9000N



# TEXTURE PER ANTE

DOOR TEXTURES



# TEXTURE PER PERSONALIZZAZIONI

CUSTOMISING TEXTURES



NOCE CANALETTO  
*Black Walnut*



GAMMA SMALL / GAMMA SMALL

ROVERE - INOX  
*OAK - STAINLESS STEEL*



STAR INOX - ROVERE TINTO / STAR STAINLESS STEEL - OAK COLOURED



STAR INOX - ROVERE NATURALE / STAR STAINLESS STEEL - NATURAL OAK

LACCATO  
*Lacquered*



GAMMA LARGE / GAMMA LARGE



GAMMA SMALL / GAMMA SMALL

ROVERE - ORO  
*OAK - GOLD*



STAR GOLD - ROVERE TINTO / STAR GOLD - OAK COLOURED



STAR GOLD - ROVERE NATURALE / STAR GOLD - NATURAL OAK



# KERAKOLL

**KERAKOLL**  
The GreenBuilding Company

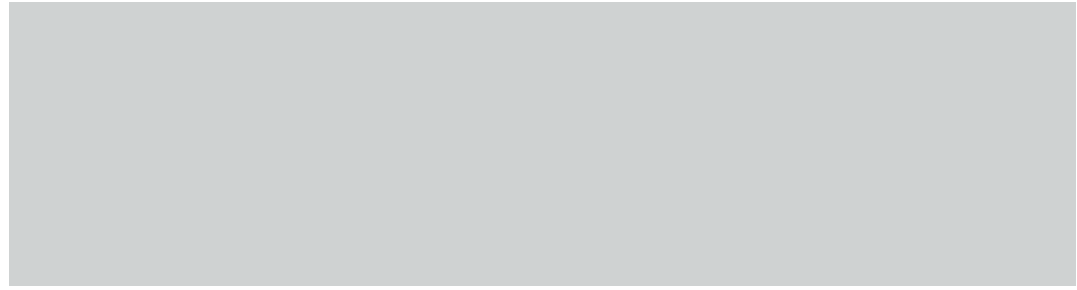

WR01



WR02



WR06



WR08





**OLDLINE ARREDAMENTI SRL**  
Via Cal Larga, 56  
31010 Mareno di Piave  
Treviso - Italy  
T. +39 0438 492506  
F. +39 0438 492549  
[www.oldline.it](http://www.oldline.it)  
[oldline@oldline.it](mailto:oldline@oldline.it)

A.D. Marco Bortolin PHOTO 3D [www.oecusdesign.it](http://www.oecusdesign.it) PREPRESS GM Studio1 (VF) PRESS [www.sincromia.it](http://www.sincromia.it) agosto 2018



